

## Aros sellos

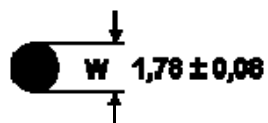

### Serie 2-XXX

N°	D.I.	D.E.	Espesor
	mm	mm	mm
2-001	0,74	2.78	1.02
2-002	1,07	3.61	1.27
2-003	1,42	4.46	1.52
2-004	1,78	5.34	
2-005	2,57	6.13	
2-006	2,90	6.46	
2-007	3,68	7.24	
2-008	4,47	8.03	
2-009	5,28	8.84	
2-010	6,07	9.63	
2-011	7,65	11.21	
2-012	9,25	12.81	
2-013	10,82	14.38	
2-014	12,42	15.98	
2-015	14,00	17.56	
2-016	15,60	19.16	
2-017	17,17	20.73	
2-018	18,77	22.33	
2-019	20,35	23.91	
2-020	21,95	25.51	
2-021	23,52	27.08	
2-022	25,12	28.68	
2-023	26,70	30.26	
2-024	28,30	31.86	
2-025	29,87	33.43	
2-026	31,47	35.03	
2-027	33,05	36.61	
2-028	34,65	38.21	
2-029	37,82	41.38	
2-030	41,00	44.56	
2-031	44,17	47.73	
2-032	47,35	50.91	
2-033	50,52	54.08	
2-034	53,70	57.26	

2-035	56,87	60.43	
2-036	60,05	63.61	
2-037	63,22	66.78	
2-038	66,40	69.96	
2-039	69,57	73.13	
2-040	72,75	76.31	
2-041	75,92	79.48	
2-042	82,27	85.83	
2-043	88,62	92.18	
2-044	94,97	98.53	
2-045	101,32	104.88	
2-046	107,67	111.23	
2-047	114,02	117.58	
2-048	120,37	123.93	
2-049	126,72	130.28	
2-050	133,07	136.63	

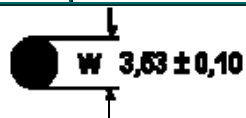

### Serie 2-XXX

N°	D.I.	D.E.
	mm	mm
2-102	1,24	6.48
2-103	2,06	7.3
2-104	2,84	8.08
2-105	3,63	8.87
2-106	4,42	9.66
2-107	5,23	10.47
2-108	6,02	11.26
2-109	7,59	12.83
2-110	9,19	14.43
2-111	10,77	16.01
2-112	12,37	17.61
2-113	13,94	19.18
2-114	15,54	20.78
2-115	17,12	22.36
2-116	18,72	23.96
2-117	20,30	25.54
2-118	21,89	27.13
2-119	23,47	28.71
2-120	25,07	30.31

N°	D.I.	D.E.
	mm	mm
2-142	59,99	65.23
2-143	61,60	66.84
2-144	63,17	68.41
2-145	64,77	70.01
2-146	66,34	71.58
2-147	67,95	73.19
2-148	69,52	74.76
2-149	71,12	76.36
2-150	72,69	77.93
2-151	75,87	81.11
2-152	82,22	87.46
2-153	88,57	93.81
2-154	94,92	100.16
2-155	101,27	106.51
2-156	107,62	112.86
2-157	113,97	119.21
2-158	120,32	125.56
2-159	126,67	131.91
2-160	133,02	138.26

2-121	26,64	31.88
2-122	28,24	33.48
2-123	29,82	35.06
2-124	31,42	36.66
2-125	32,99	38.23
2-126	34,59	39.83
2-127	36,17	41.41
2-128	37,77	43.01
2-129	39,34	44.58
2-130	40,94	46.18
2-131	42,52	47.76
2-132	44,12	49.36
2-133	45,69	50.93
2-134	47,29	52.53
2-135	48,90	54.14
2-136	50,47	55.71
2-137	52,07	57.31
2-138	53,64	58.88
2-139	55,25	60.49
2-140	56,82	62.06
2-141	58,42	63.66

2-161	139,37	144.61
2-162	145,72	150.96
2-163	152,07	157.31
2-164	158,42	163.66
2-165	164,77	170.01
2-166	171,12	176.36
2-167	177,47	182.71
2-168	183,82	189.06
2-169	190,17	195.41
2-170	196,52	201.76
2-171	202,87	208.11
2-172	209,22	214.46
2-173	215,57	220.81
2-174	221,92	227.16
2-175	228,27	233.51
2-176	234,62	239.86
2-177	240,97	246.21
2-178	247,32	252.56

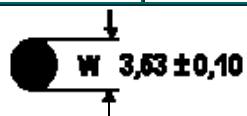

### Serie 2-XXX

N°	D.I.	D.E.
	mm	mm
2-201	4,34	11.4
2-202	5,94	13
2-203	7,52	14.58
2-204	9,12	16.18
2-205	10,69	17.75
2-206	12,29	19.35
2-207	13,87	20.93
2-208	15,47	22.53
2-209	17,04	24.1
2-210	18,64	25.7
2-211	20,22	27.28
2-212	21,82	28.88
2-213	23,39	30.45
2-214	24,99	32.05

N°	D.I.	D.E.
	mm	mm
2-244	107,54	114.6
2-245	110,72	117.78
2-246	113,89	120.95
2-247	117,07	124.13
2-248	120,24	127.3
2-249	123,42	130.48
2-250	126,59	133.65
2-251	129,77	136.83
2-252	132,94	140
2-253	136,12	143.18
2-254	139,29	146.35
2-255	142,47	149.53
2-256	145,64	152.7
2-257	148,82	155.88

2-215	26,57	33.63
2-216	28,17	35.23
2-217	29,74	36.8
2-218	31,34	38.4
2-219	32,92	39.98
2-220	34,52	41.58
2-221	36,09	43.15
2-222	37,69	44.75
2-223	40,87	47.93
2-224	44,04	51.1
2-225	47,22	54.28
2-226	50,39	57.45
2-227	53,37	60.43
2-228	56,74	63.8
2-229	59,92	66.98
2-230	63,09	70.15
2-231	66,27	73.33
2-232	69,44	76.5
2-233	72,62	79.68
2-234	75,79	82.85
2-235	78,97	86.03
2-236	82,14	89.2
2-237	85,32	92.38
2-238	88,49	95.55
2-239	91,67	98.73
2-240	94,84	101.9
2-241	98,02	105.08
2-242	101,19	108.25
2-243	104,37	111.43

2-258	151,99	159.05
2-259	158,34	165.4
2-260	164,69	171.75
2-261	171,04	178.1
2-262	177,39	184.45
2-263	183,74	190.8
2-264	190,09	197.15
2-265	196,44	203.5
2-266	202,79	209.85
2-267	209,14	216.2
2-268	215,49	222.55
2-269	221,84	228.9
2-270	228,19	235.25
2-271	234,54	241.6
2-272	240,89	247.95
2-273	247,24	254.3
2-274	253,59	260.65
2-275	266,29	273.35
2-276	278,99	286.05
2-277	291,69	298.75
2-278	304,39	311.45
2-279	329,79	336.85
2-280	355,19	362.25
2-281	380,59	387.65
2-282	405,26	412.32
2-283	430,66	437.72
2-284	456,06	463.12

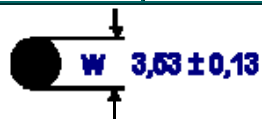

### Serie 2-XXX

N°	D.I.	D.E.
	mm	mm
2-309	10,46	21.12
2-310	12,07	22.73
2-311	13,64	24.3
2-312	15,24	25.9
2-313	16,81	27.47
2-314	18,42	29.08

N°	D.I.	D.E.
	mm	mm
2-353	126,37	137.03
2-354	129,54	140.2
2-355	132,72	143.38
2-356	135,89	146.55
2-357	139,07	149.73
2-358	142,24	152.9

2-315	19,99	30.65
2-316	21,59	32.25
2-317	23,16	33.82
2-318	24,77	35.43
2-319	26,34	37
2-320	27,94	38.6
2-321	29,51	40.17
2-322	31,12	41.78
2-323	32,69	43.35
2-324	34,29	44.95
2-325	37,47	48.13
2-326	40,64	51.3
2-327	43,82	54.48
2-328	46,99	57.65
2-329	50,17	60.83
2-330	53,34	64
2-331	56,52	67.18
2-332	59,69	70.35
2-333	62,87	73.53
2-334	66,04	76.7
2-335	69,22	79.88
2-336	72,39	83.05
2-337	75,57	86.23
2-338	78,74	89.4
2-339	81,92	92.58
2-340	85,09	95.75
2-341	88,27	98.93
2-342	91,44	102.1
2-343	94,62	105.28
2-344	97,79	108.45
2-345	100,97	111.63
2-346	104,14	114.8
2-347	107,32	117.98
2-348	110,49	121.15
2-349	113,67	124.33
2-350	116,84	127.5
2-351	120,02	130.68
2-352	123,19	133.85

2-359	145,42	156.08
2-360	148,59	159.25
2-361	151,77	162.43
2-362	158,12	168.78
2-363	164,47	175.13
2-364	170,82	181.48
2-365	177,17	187.83
2-366	183,52	194.18
2-367	189,87	200.53
2-368	196,22	206.88
2-369	202,57	213.23
2-370	208,92	219.58
2-371	215,27	225.93
2-372	221,62	232.28
2-373	227,97	238.63
2-374	234,32	244.98
2-375	240,67	251.33
2-376	247,02	257.68
2-377	253,37	264.03
2-378	266,07	276.73
2-379	278,77	289.43
2-380	291,47	302.13
2-381	304,17	314.83
2-382	329,57	340.23
2-383	354,97	365.63
2-384	380,37	391.03
2-385	405,26	415.92
2-386	430,66	441.32
2-387	456,06	466.72
2-388	481,41	492.07
2-389	506,81	517.47
2-390	532,21	542.87
2-391	557,61	568.27
2-392	582,68	593.34
2-393	608,08	618.74
2-394	633,48	644.14
2-395	658,88	669.54

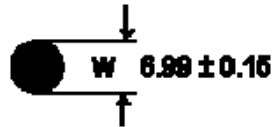

### Serie 2-XXX

N°	D.I.	D.E.
	mm	mm
2-425	113,67	127,65
2-426	116,84	130,82
2-427	120,02	134
2-428	123,19	137,17
2-429	126,37	140,35
2-430	129,54	143,52
2-431	132,72	146,7
2-432	135,89	149,87
2-433	139,07	153,05
2-434	142,24	156,22
2-435	145,42	159,4
2-436	148,59	162,57
2-437	151,77	165,75
2-438	158,12	172,1
2-439	164,47	178,45
2-440	170,82	184,8
2-441	177,17	191,15
2-442	183,52	197,5
2-443	189,97	203,95
2-444	196,22	210,2
2-445	202,57	216,55
2-446	215,27	229,25
2-447	227,97	241,95
2-448	240,67	254,65
2-449	253,37	267,35
2-450	266,07	280,05

N°	D.I.	D.E.
	mm	mm
2-451	278,77	292,75
2-452	291,47	305,45
2-453	304,17	318,15
2-454	316,87	330,85
2-455	329,57	343,55
2-456	342,27	356,25
2-457	354,97	368,95
2-458	367,67	381,65
2-459	380,37	394,35
2-460	393,07	407,05
2-461	405,26	419,24
2-462	417,96	431,94
2-463	430,66	444,64
2-464	443,36	457,34
2-465	456,06	470,04
2-466	468,76	482,74
2-467	481,46	495,44
2-468	494,16	508,14
2-469	506,86	520,84
2-470	532,26	546,24
2-471	557,66	571,64
2-472	582,68	596,66
2-473	608,08	622,06
2-474	633,48	647,46
2-475	658,88	672,86



### Serie

### 3-XXX

1,42 a 2,46 ± 0,08 / 2,95 a 3,00 ± 0,10

N°	D.I.	D.E.	Espesor
	mm	mm	mm
3-901	4,70	7,54	1,42
3-902	6,07	9,33	1,63
3-903	7,65	10,91	1,63

3-904	8,92	12.58	1,83
3-905	10,52	14.18	1,83
3-906	11,89	15.85	1,98
3-907	13,46	17.62	2,08
3-908	16,36	20.78	2,21
3-909	17,93	22.85	2,46
3-910	19,18	24.1	2,46
3-911	21,92	27.82	2,95
3-912	23,47	29.37	2,95
3-913	25,04	30.94	2,95
3-914	26,59	32.49	2,95
3-916	29,74	35.64	2,95
3-918	34,42	40.32	2,95
3-920	37,47	43.47	3,00
3-924	43,69	49.69	3,00
3-928	53,09	59.09	3,00
3-932	59,36	65.36	3,00